

# Park West

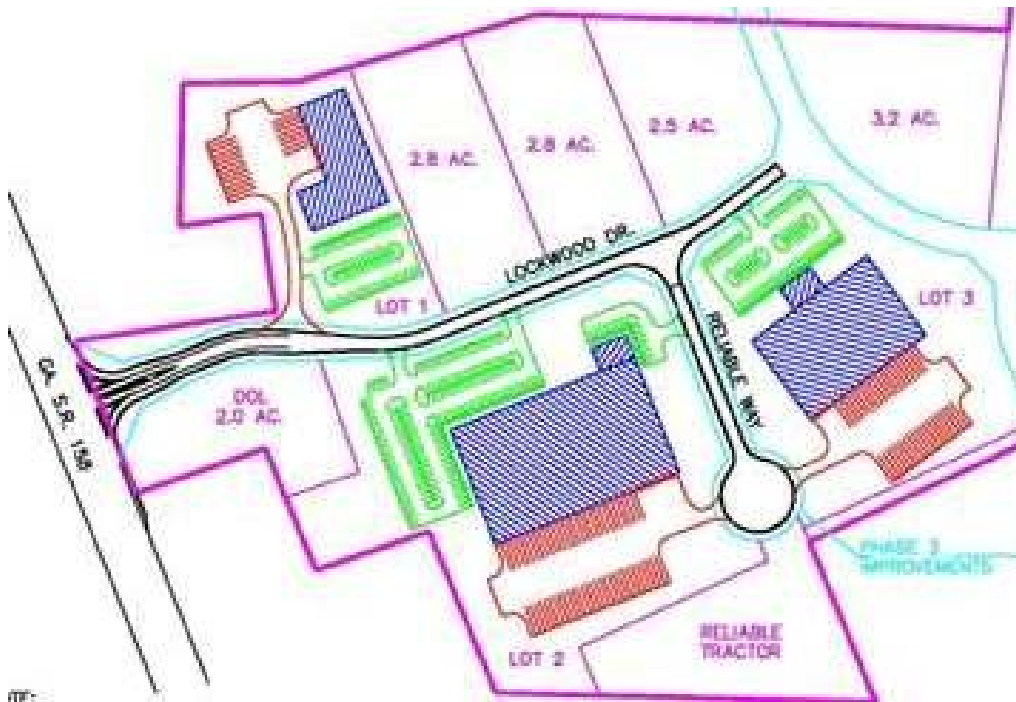

- Direct 4-lane access to highways 158 & 206 with 4-lane connection to interstates I-75, I-95, I-16 & I-10
- Easy access to Georgia's seaports and JaxPort in Florida
- Utilities: 12" water, 10" sewer, and 8" gas.
- Footprints represent possible development opportunities.
- Price: \$20,000 to \$35,000 per acres

## Property Details

**Listing ID** 105

**Price** \$600,000

**Status:** Active

**Lot Size** 10 acre(s)

## Additional Information

- Main Area: Douglas
- Highway: 158 206
- Rail: No
- Total Available Acreage: 70 acre(s)
- Smallest Tract: 3 acre(s)
- Ownership: Public
- Water: 10
- Electricity: Yes

- County: Coffee
- Airport: Douglas Municipal Airport
- Environmental Site Assessment
- Largest Tract: 10 acre(s)
- Current Zoning: Industrial
- Sewer: 12
- Gas: 8

## Contact



JoAnne Lewis, President  
Community of Douglas